

11/27/06 - 3:29pm - Gpg - P:\S\SESD00000001\0400CAD\DWG\galls\PreimApron-gpg-Layout_FN.dwg

SEASIDE MUNICIPAL AIRPORT PRELIMINARY APRON LAYOUT A 11/27/06

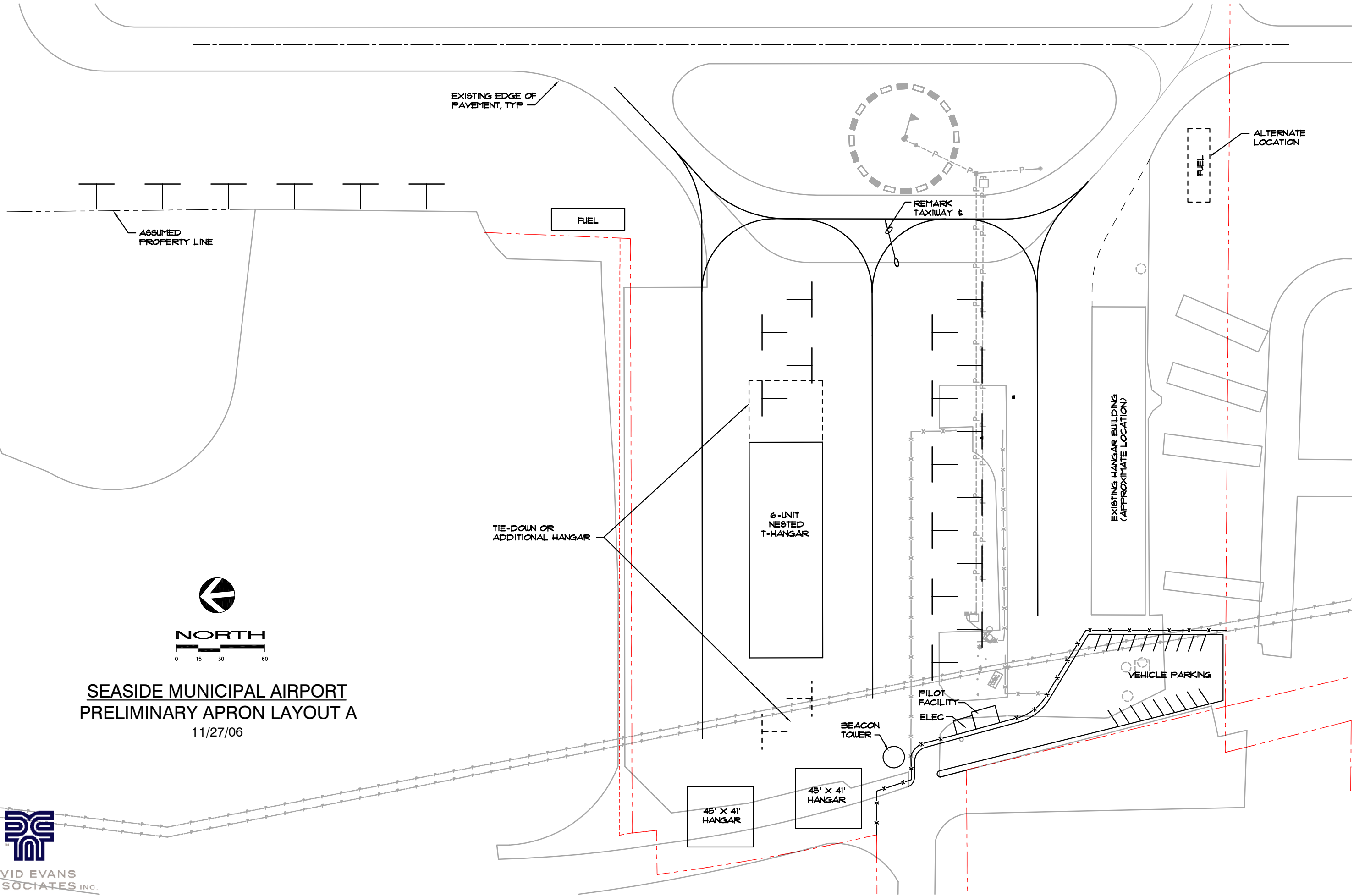
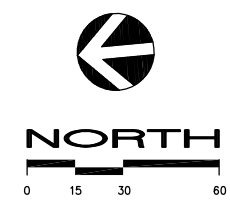

DAVID EVANS
AND ASSOCIATES INC.